



RENLINE

32 Catamount Drive Milton VT. 05468

Renline LED or HID Headlight Upgrade Kit

911/912/964 65-94

Installation Guide



Read all instructions before beginning the install to become familiar with the install procedure.

Be sure power is turned off to the headlights during the install procedure.

Unpack the headlights and all components from the protective packaging. Check that all parts are included and undamaged in the shipping container before you begin the install.

Included with headlight kit:

1. Two headlight assemblies supplied with the correct color of projector shrouds installed and two projector surrounds specified per order.
2. Two lenses supplied specified per order.
3. Two headlight trim rings supplied specified per order.
4. One hardware kit:
 - 4.1. Two 5mm x 30mm trim ring screws
 - 4.2. Two fender-to-headlight gaskets
 - 4.3. Two lens gaskets
 - 4.4. Two 9007 to H4 wiring harness adaptors



RENNLINE

32 Catamount Drive Milton VT. 05468

- 1) Uninstall the existing headlights.
 - a) Remove the trim ring screw at the bottom of the trim ring.
 - b) Pull the trim ring from the headlight starting at the bottom of the headlight working around the headlight until the trim ring releases.
 - c) Remove the headlight retaining screw at the bottom of the headlight, fully remove the old headlight assembly. **BE CAREFUL WHEN REMOVING, DO NOT PULL ON THE WIRES!**
 - d) Unplug the headlight wires from the vehicle wiring harness.
 - e) Remove the old fender-to-headlight gasket from the edge of the fender's headlight bucket.
- 2) Install the new fender-to-headlight gasket around the headlight bucket.



- 3) If necessary, install the 9007 to H4 wiring harness adaptor. (some vehicles do not require this)





RENNLINE

32 Catamount Drive Milton VT. 05468

- 4) Connect the headlight assembly to the wiring. Spread out the braided heatsink bands before installing the headlight.

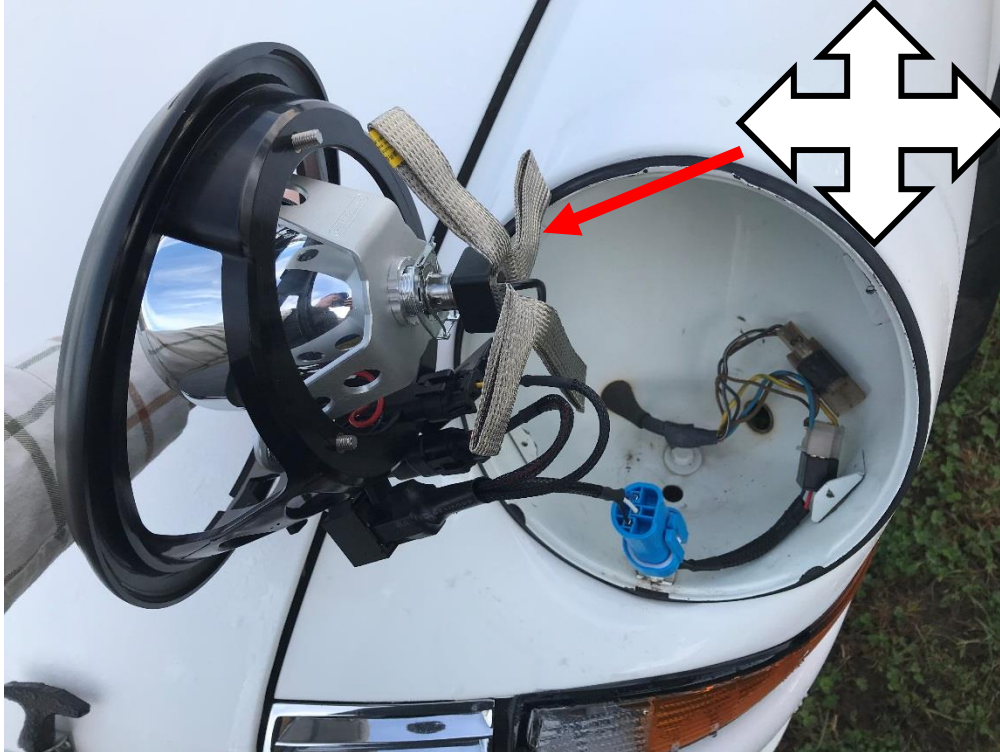

- 5) Align the top of the headlight assembly, marked by the arrow on the headlight frame, to the top of the fender's headlight bucket. Hook the lip of the headlight over the lip of the fender's headlight bucket.





RENLINE

32 Catamount Drive Milton VT. 05468

- 6) Secure the headlight into the fender's headlight bucket using the provided trim screw.
- 7) Turn the headlights on, only use low beam to set the three adjustment screws to align the headlight beam as described below:

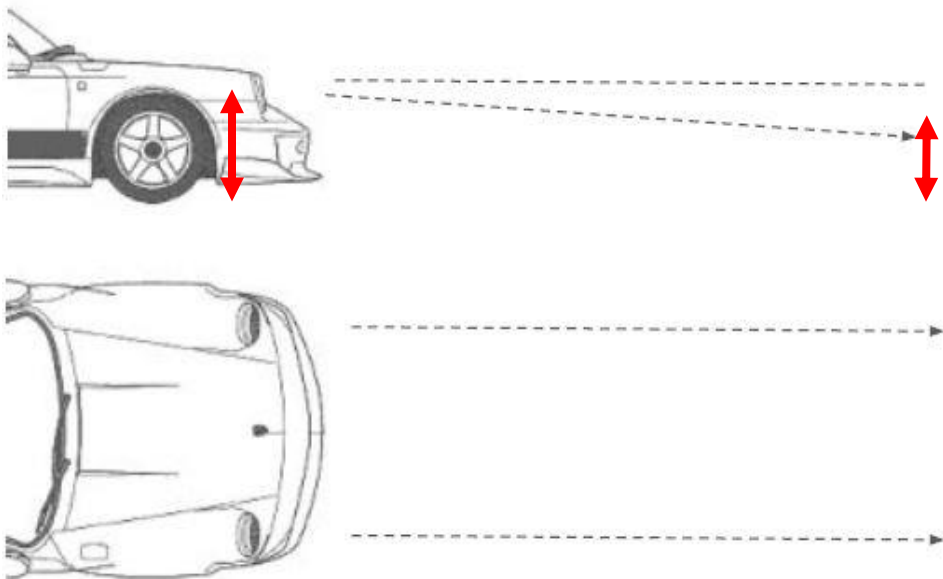
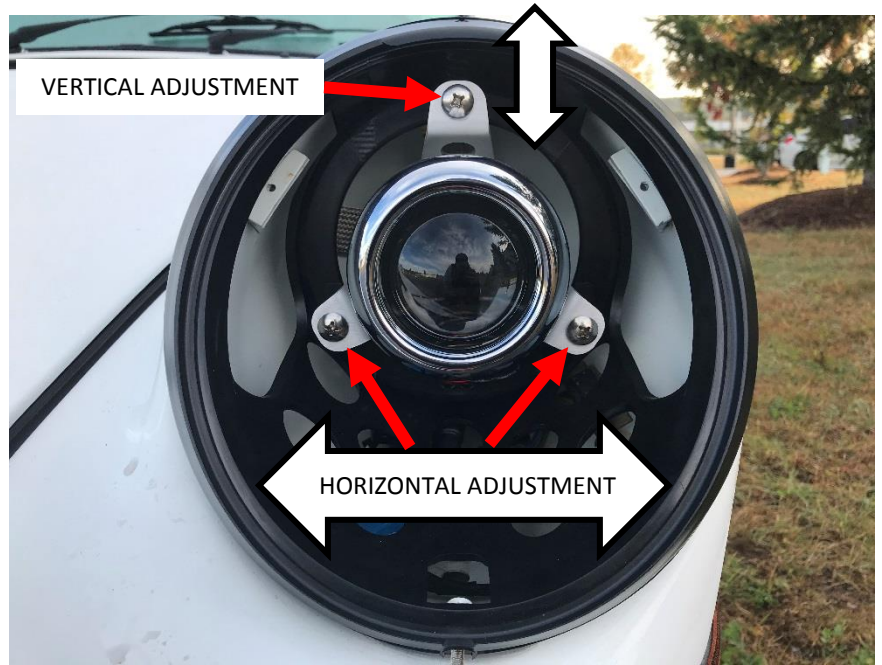

The upper cutoff shadow line with low beams should be 2" lower than the height of the projector from the ground when measured 25' from the vehicle. This measurement is easily taken with the vehicle parked 25' from a wall, measuring the cutoff line on the wall.

The center of the cutoff line should be aligned with the center of each headlight when measured 25' from the vehicle.



RENNLINE

32 Catamount Drive Milton VT. 05468

- 8) Install the projector surround into the headlight frame. Be sure the surround sits fully into the recessed channel of the headlight frame. Align the cut in the rim of the surround to the bottom of the headlight frame.



- 9) Install the supplied lens gasket to the supplied lens. Stretch the gasket over the edge of the lens. Be sure the ribs of the gasket face away from the lens.





RENNLINE

32 Catamount Drive Milton VT. 05468

- 10) Install the lens to the headlight frame. Start at the top of the headlight frame and hook the lens under the retaining hook. Be sure to push the bottom of the lens into the channel of the headlight frame.



- 11) Remove the previously installed headlight retaining screw. Install the trim ring over the headlight frame. Start at the top of the trim ring and push the trim ring down over the headlight frame until the screw hole at the bottom lines up with the headlight bucket threads.



- 12) Installation complete.



RENNLINE

32 Catamount Drive Milton VT. 05468

Rennline LED or HID Headlight Angel LED Installation Guide



Read all instructions before beginning the install to become familiar with the install procedure.

This kit is designed to be installed into the Rennline LED or HID Headlight Upgrade only. You must purchase the Rennline LED or HID Headlight Upgrade kit separately.

Unpack the Angel LED kit. Check to be sure all parts are included and undamaged before you begin the install.

Included with Angel LED kit:

1. Two Angel LEDs
2. Two LED control modules
3. Six small diameter spade terminals
4. Six large diameter spade terminals
5. Two cable clamps
6. Two screws
7. Two zip ties



RENNLINE

32 Catamount Drive Milton VT. 05468

Uninstall the projector shroud from the headlight assembly. Remove the four screws holding the projector shroud to the projector. Remove the lower two screws by inserting the screw driver through the holes in the projector bracket.



1. Install the Angel LED into the projector shroud. Orient the wires to the bottom of the shroud. The bottom is designated by the screw mounting locations that are further apart.

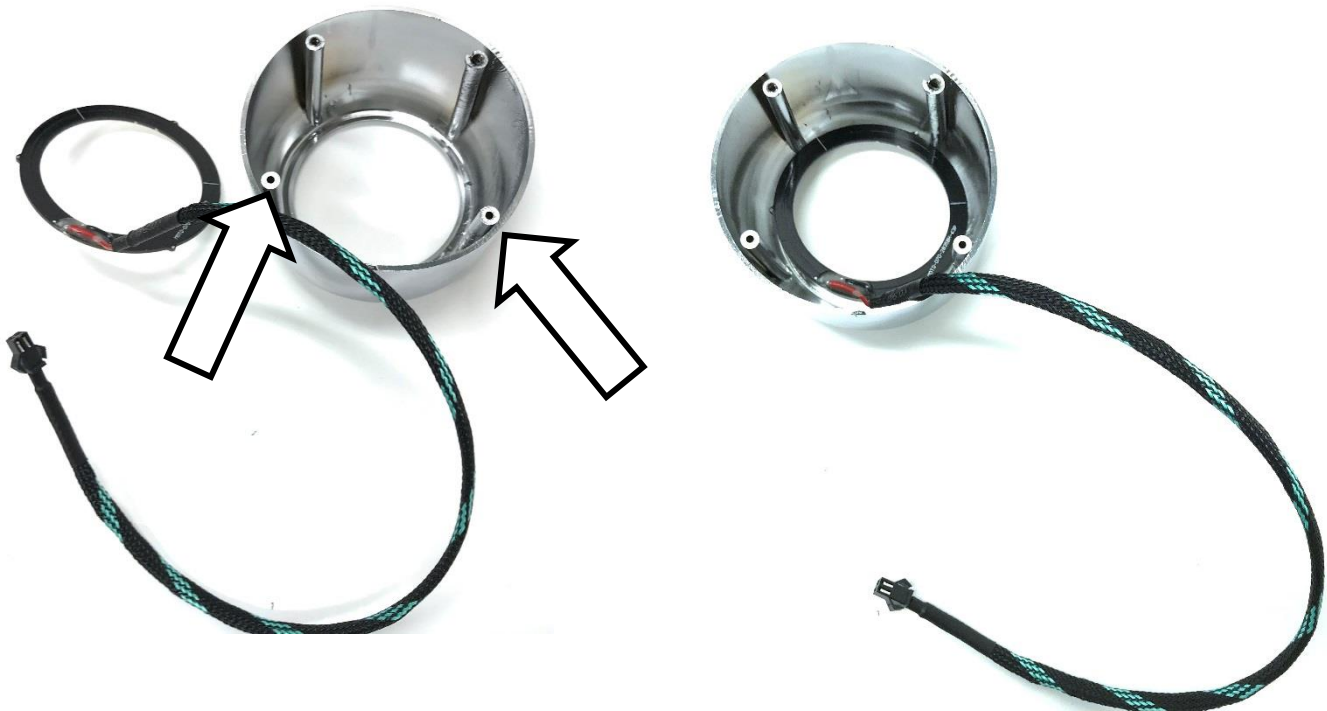



RENNLINE

32 Catamount Drive Milton VT. 05468

2. Reinstall the projector shroud / Angel LED assembly to the projector using the four screws previously removed. Before screws are fully tight, be sure Angel LED ring is centered on the front of the projector.



3. Secure the LED power module to the headlight frame using the supplied zip tie. Secure the excess wires using the supplied wire clamp and screw, screwing the wire clamp to the body of the headlight frame.

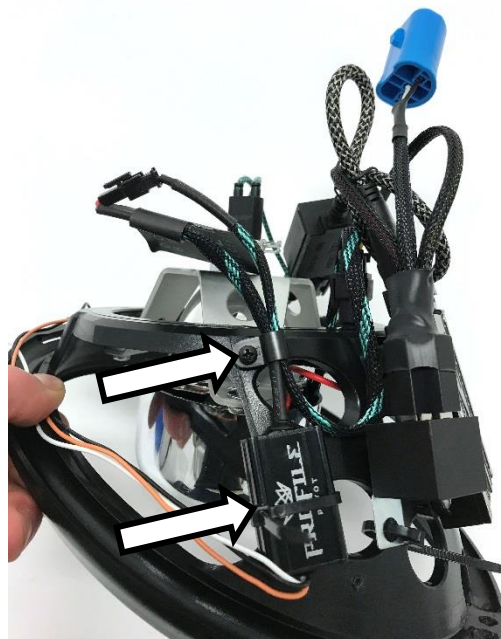



RENLINE

32 Catamount Drive Milton VT. 05468

4. Use the supplied terminals to complete the wiring:
 - a) Use the small diameter supplied spade terminals for the three wires coming from the LED module
 - b) Use the larger diameter supplied spade terminals for the connections to the vehicle chassis.
 - i) Connect the black wire from the LED module to vehicle ground wire.
 - ii) Connect the white wire to the parking light wire in the headlight bucket
 - iii) Connect the orange wire to the turn signal light wire in the headlight bucket.

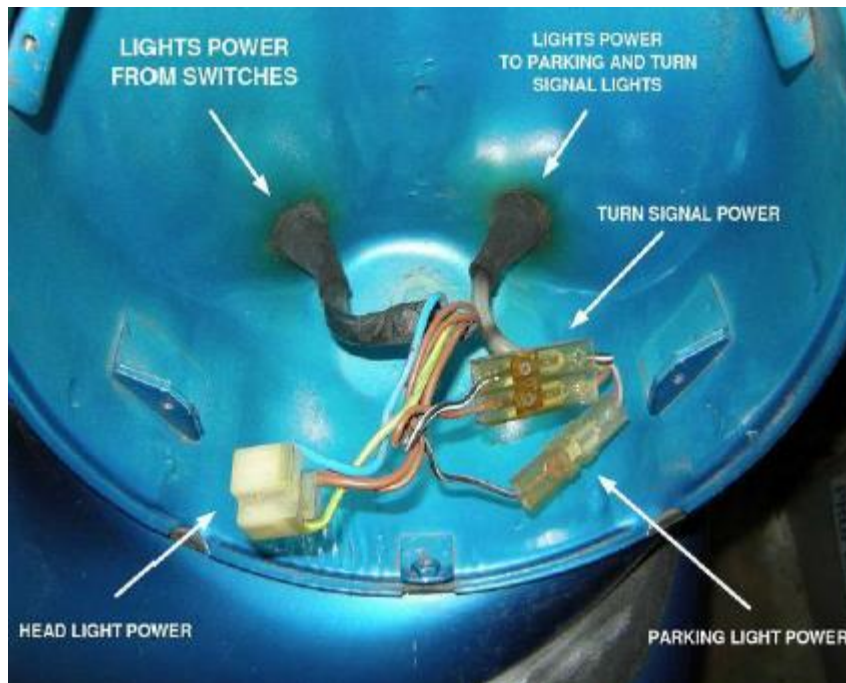

5. Refer to the Renline LED Headlight Upgrade kit Installation Guide to complete the headlight installation.



RENNLINE

32 Catamount Drive Milton VT. 05468

Rennline LED or HID Headlight Parking Light LED Installation Guide



Read all instructions before beginning the install to become familiar with the install procedure.

This kit is designed to be installed into the Rennline LED or HID Headlight Upgrade only. You must purchase the Rennline LED or HID Headlight Upgrade kit separately.

Unpack the Parking Light LED kit. Check to be sure all parts are included and undamaged before you begin the install.

Included with Parking Light LED kit:

1. Two Parking LEDs
2. Four small diameter spade terminals
3. Four large diameter spade terminals



RENNLINE

32 Catamount Drive Milton VT. 05468

1. Mark the location of the parking light on the back of the projector surround. Use the rounded edge of the cutout in the frame indicated below to mark the center location.



2. Remove the projector surround from the headlight frame.
3. Drill a 3/8" hole at the marked location.
4. Thread the parking light through from the front of the projector surround. Secure in place using the supplied nut. Finger tight only.





RENLINE

32 Catamount Drive Milton VT. 05468

5. Use the supplied terminals to complete the wiring:
 - a) Use the small diameter supplied spade terminals for the two wires coming from the LEDs
 - b) Use the larger diameter supplied spade terminals for the connections to the vehicle chassis.
 - c) Connect the black wire from the Parking LED to the vehicle wiring harness ground wire.
 - d) Connect the red wire from the Parking LED to the parking light wire in the vehicle wiring harness.

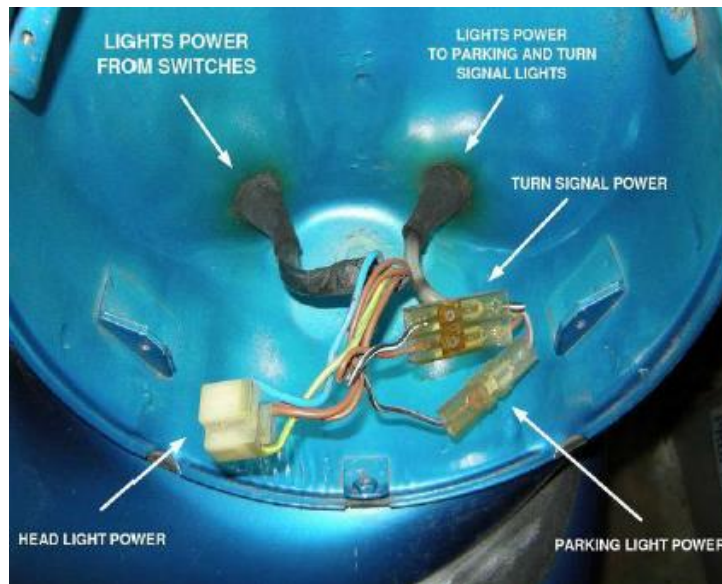

6. Refer to the Renline LED Headlight Upgrade kit Installation Guide to complete the headlight installation.



RENNLINE

EL13

Rennline LED Headlight Conversion - Plug and Play - Rev2



Frequently Asked Questions

When assembling the headlights, How do I properly seat the trim ring over the lens and bucket?

There are two ridges molded into the gasket that encapsulates the edge of the lens. A larger more defined ridge that runs along the outside edge and smaller less defined one the inside edge of the gasket. The ridges should be facing away from the lens. Position the larger ridge just past the edge of the lens. Since all the components are oval shaped, correct orientation of the shroud, lens and trim ring will be vital to the proper fitment of the ring as well as gasket placement. This is covered in our

YouTube Installation Video

What is the best way to attach the trim ring to the headlight housing?

The trim ring is pressure fit. Starting the trim ring at the 12 o'clock position and pressing on the 6 o'clock position while maintaining the screw holes alignment, will result in proper fit of the trim ring. If completed properly, the lens gasket should not be visible.

How can I make sure the gasket between the headlight housing and fender is not visible

Ensure the notch on the back side of the headlight housing is correctly hooked over the tab in the fender. With the headlight securely locked into place, apply downward force with your hand pushing the headlight down and simultaneously fastening the retaining screw at the bottom of the headlight.

Will my factory trim rings work with these headlights?

Our headlights are designed around the OEM design. In theory, your original H4 rings should fit. Sugar scoop style trim rings will not work. Due to the variables of age, condition and deformation, Rennline can not guarantee your specific trim rings will install without any issue.